

ROUTE CHANGE REQUEST – US 29

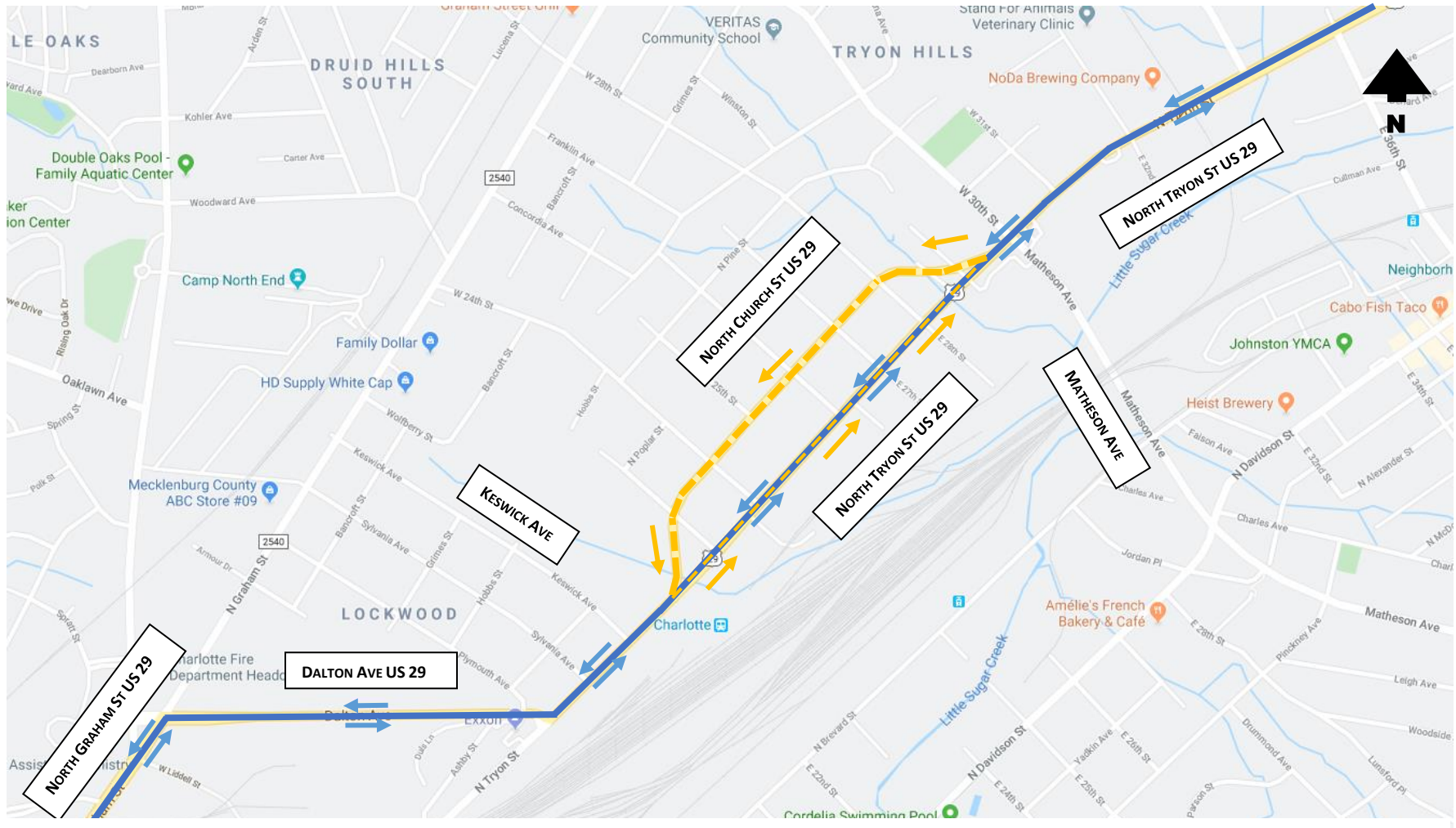

| | | | |
|----------|--|-----------------|---------------------|
| EXISTING | | US 29 | |
| PROPOSED | | NORTH CHURCH ST | ONE WAY SOUTH BOUND |
| PROPOSED | | NORTH TRYON ST | ONE WAY NORTH BOUND |