

This document, together with the concepts and designs presented herein, as an instrument of service, is intended only for the specific purpose and client for which it was prepared. Reuse of and improper reliance on this document without written authorization and adaptation by Kinney-Horn and Associates, Inc. shall be without liability to Kinney-Horn and Associates, Inc.

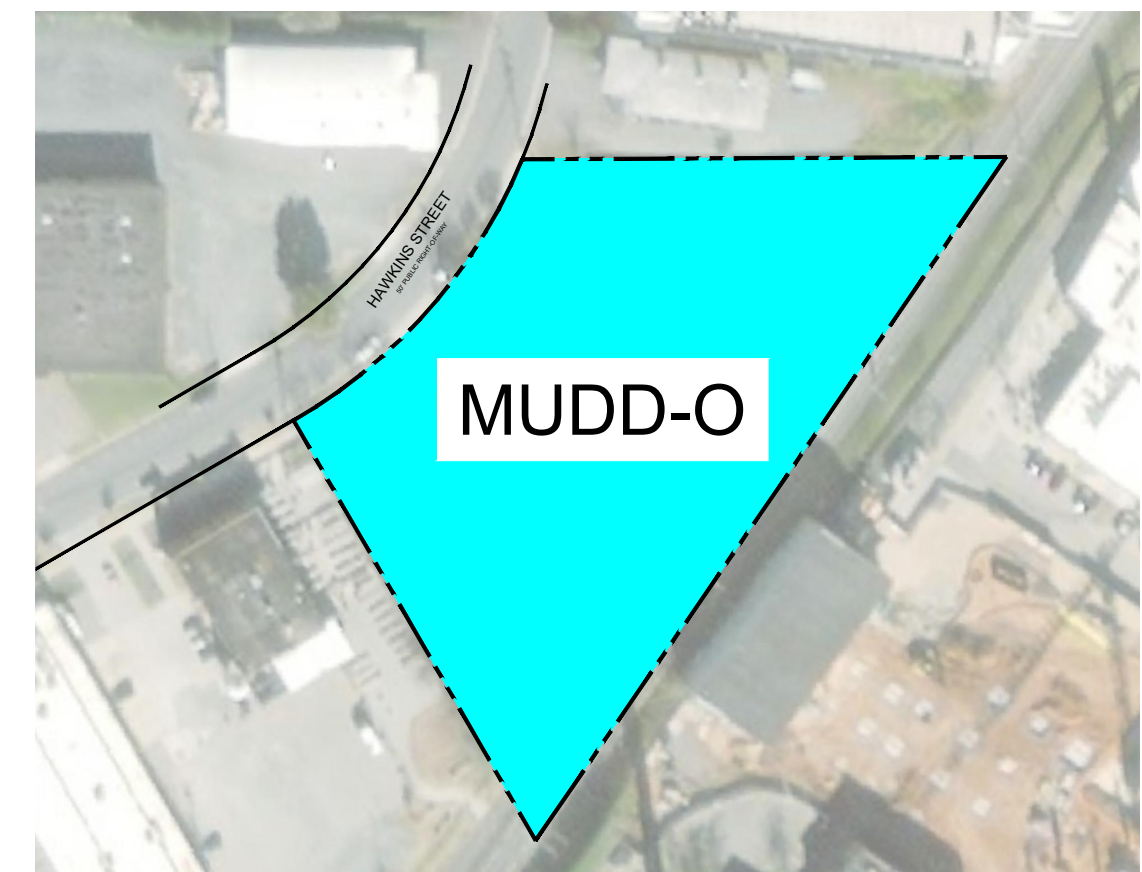

VICINITY MAP
NOT TO SCALE

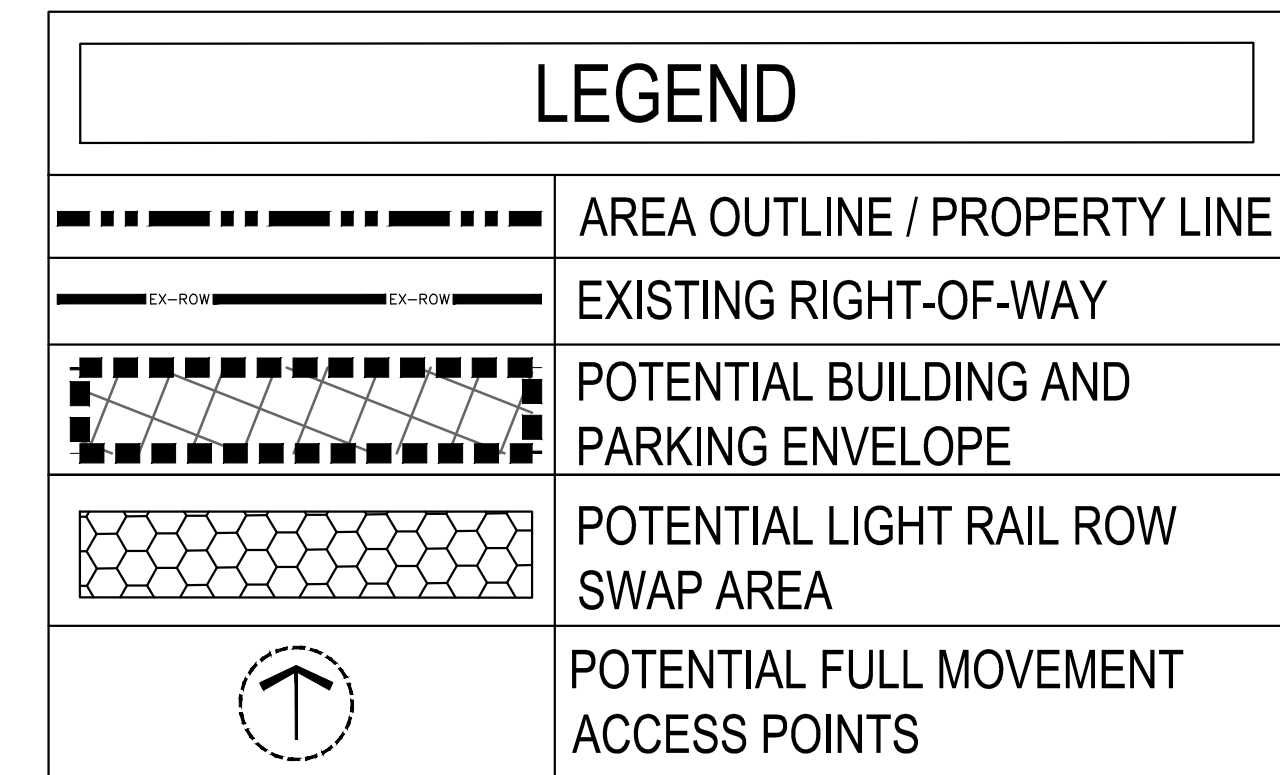

EXISTING ZONING MAP
NOT TO SCALE

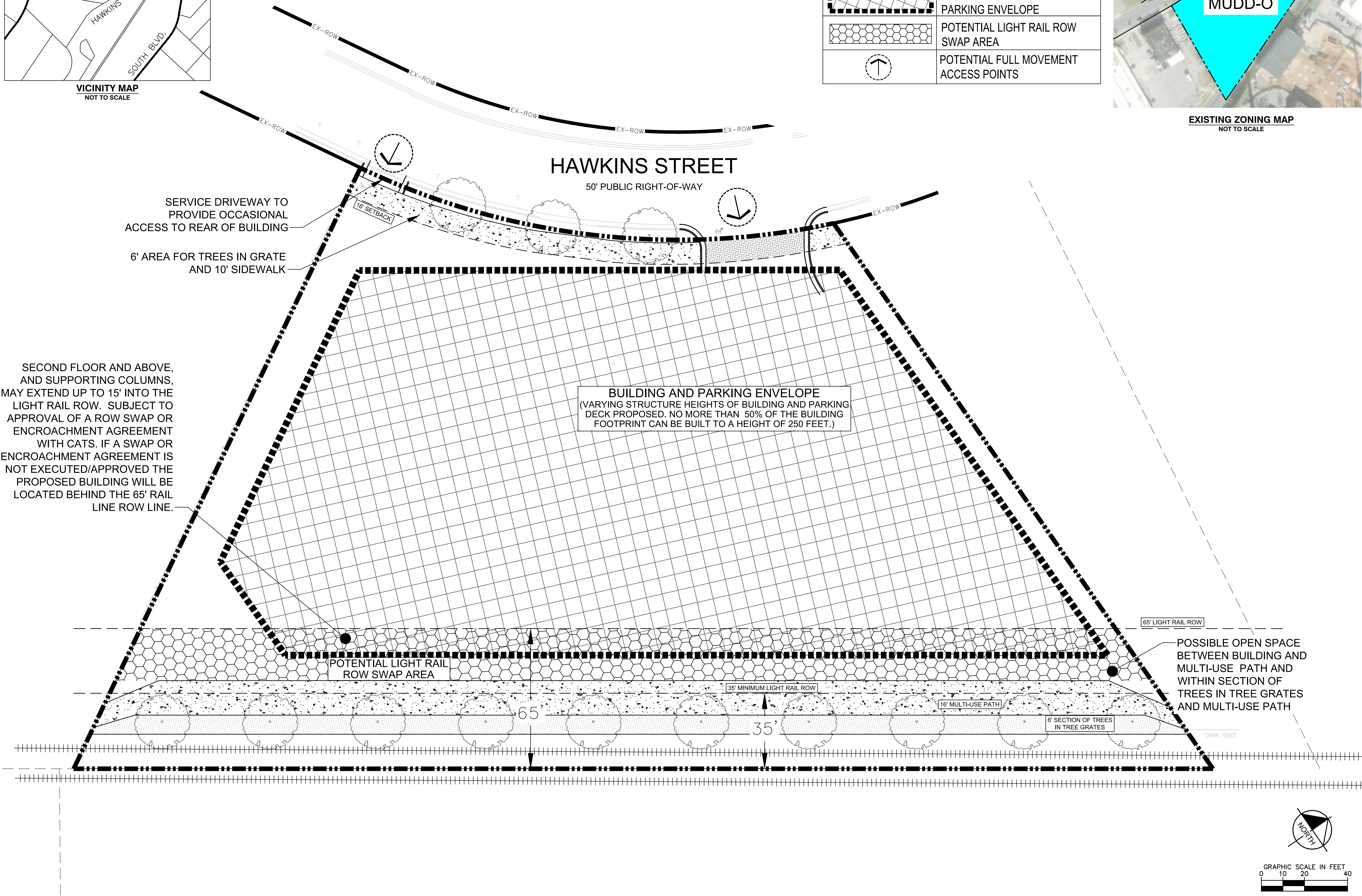

Kimley»»Horn
© 2019 KIMLEY-HORN AND ASSOCIATES, INC.
200 SOUTH TRYON STREET SUITE 200, CHARLOTTE, NC 28202
PHONE: 704-333-5131
WWW.KIMLEY-HORN.COM
NC LICENSE #F-0102

PRELIMINARY
DOCUMENT

KHA PROJECT 01929011
DATE 3/11/2019
SCALE AS SHOWN
DESIGNED BY JH
DRAWN BY KS
CHECKED BY JH

TECHNICAL DATA SHEET

PORTMAN SOUTHBEND
PREPARED FOR
PORTMAN HOLDINGS

SHEET NUMBER
RZ - 1

This document, together with the concepts and designs presented herein, as an instrument of service, is intended only for the specific purpose and client for which it was prepared. Reuse of and improper reliance on this document without written authorization and adaptation by Kimley-Horn and Associates, Inc. shall be without liability to Kimley-Horn and Associates, Inc.

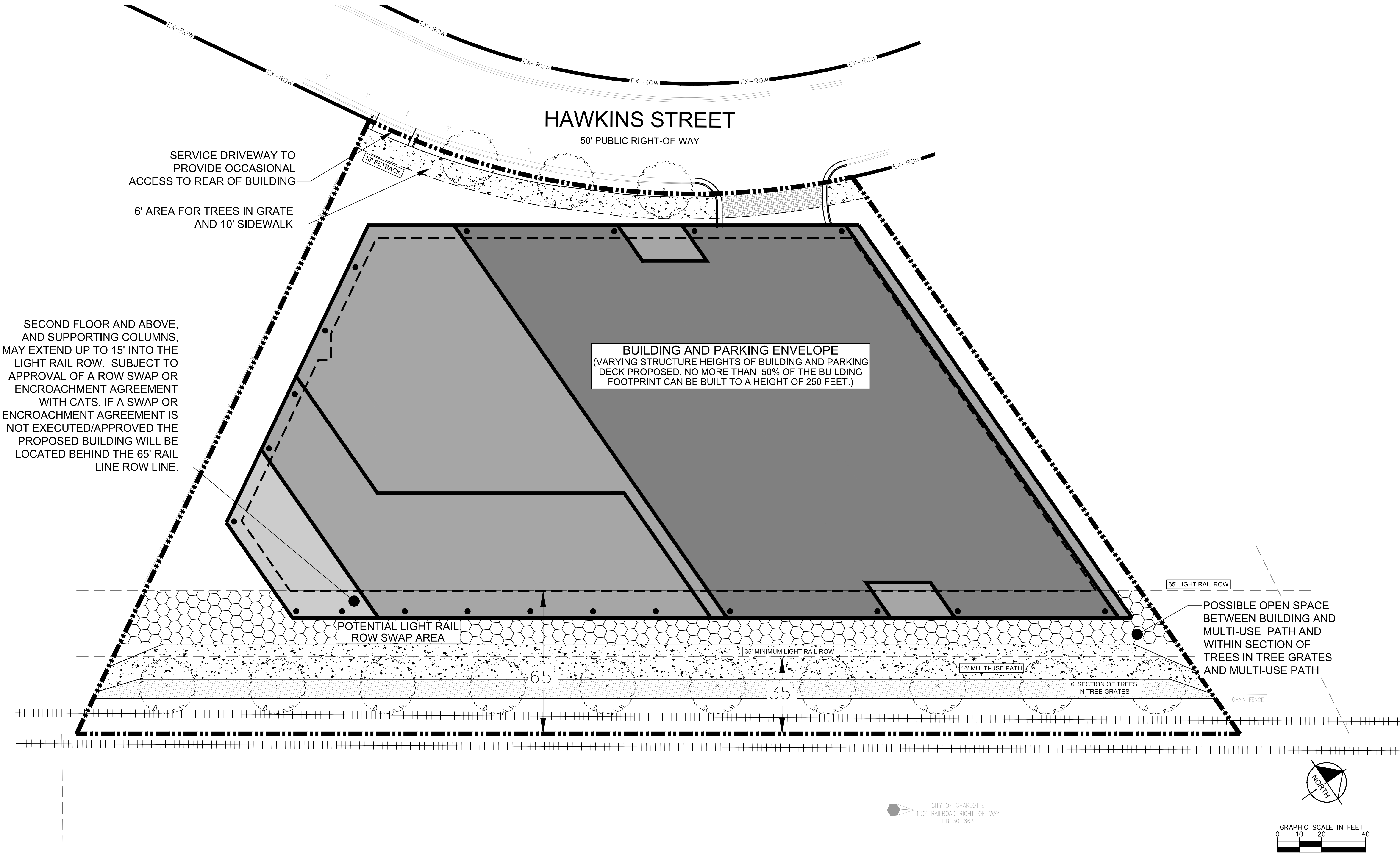

SHEET NUMBER		PORTMAN SOUTHEND PREPARED FOR PORTMAN HOLDINGS		CITY OF CHARLOTTE		NORTH CAROLINA	
RZ - 2							
		KHA PROJECT 01929011		DATE 3/11/2019			
		SCALE AS SHOWN		DESIGNED BY JH			
		DRAWN BY KS		CHECKED BY JH			
		PRELIMINARY DOCUMENT					
		Kimley»»Horn					
		© 2019 KIMLEY-HORN AND ASSOCIATES, INC. 200 SOUTH TRYON STREET SUITE 200, CHARLOTTE, NC 28202 PHONE: 704-333-5131 WWW.KIMLEY-HORN.COM NC LICENSE #F-0102					
				REVISIONS		No.	BY

