

## BACKFLOW PREVENTER DETAIL

SCALE: N.T.S.

## BACKFLOW PREVENTER NOTES:

NEW COMMERCIAL, LAWN IRRIGATION, OR FIRE LINE SERVICE WITH NEW SERVICE, LAWN, OR FIRE SYSTEM TIED TO NEW METER.

### REQUIREMENTS FOR BACKFLOW PREVENTION ASSEMBLY INSTALLATION

A. INSTALL ASSEMBLY BEFORE ANY BRANCHES IN NEW SYSTEM OUTSIDE ZONING AREAS, PER CMUD STANDARD DETAILS. ON FIRE LINES SHUT-OFF VALVES, SHALL BE OS&Y TYPE, AND BE PROVIDED WITH SUPERVISORY TAMPER SWITCHES WITH TROUBLE SIGNAL TO GO TO THE EMERGENCY CONTROL STATION AS REQUIRED BY CURRENT BUILDING CODE.

B. LOCATE 12" ABOVE GROUND MIN. 30" MAX. IN HORIZONTAL DIRECTION. 30" MIN. CLEAR OF ANY PERMANENT OBSTRUCTION. NO STRAINERS SHALL BE INSTALLED ON FIRE SYSTEMS.

C. USE TYPE "L" OR "K" COPPER, D.I.P. (3"-10") OR GALVANIZED STEEL PIPE (1" DIA. MIN.), FROM 5' BEFORE TO 5' PAST ASSEMBLY.

D. PROTECTIVE STRUCTURE REQUIRED WITH INSULATED PROTECTION 7.4R FACTOR MINIMUM. INSULATION SHALL NOT BE WRAPPED AROUND ASSEMBLY. ALL ASSEMBLIES USED ON FIRE LINE SERVICES SHALL BE PROTECTED TO MIN. 40 DEGREES OR AS REQUIRED BY CURRENT BUILDING CODE.

E. LOCATION OF CONNECTION AND BACKFLOW PREVENTION ASSEMBLY WILL BE LOCATED OUTSIDE AND ACCESSIBLE TO CMUD AT ALL TIMES.

F. IF UNIONS ARE USED (3/4"-2"), CAPS MUST BE PROVIDED AND STORED WITH ASSEMBLY, FOR USE ANY TIME THE UNIT IS REMOVED. IT IS REQUIRED TO CAP REMAINING PIPING TO SERVICE LINE AND IS SUBJECT TO CCU AT ANY TIME ASSEMBLY IS REMOVED.

G. ASSEMBLY REQUIRED TO BE INSTALLED BY A NC STATE LICENSED PLUMBER, UTILITY CONTRACTOR, OR NC STATE LICENSED FIRE SPRINKLER CONTRACTOR.

H. THERE SHALL BE NO TAPS, PIPING BRANCHES, UNAPPROVED BYPASS PIPING, HYDRANTS, FIRE DEPT. CONNECTION POINTS, OR OTHER WATER-USING APPURTENANCES CONNECTED TO THE SUPPLY LINE BETWEEN ANY WATER METER AND ITS CCU-REQUIRED BACKFLOW PREVENTERS.

I. 1" REDUCED PRESSURE PRINCIPLE BACKFLOW PREVENTION ASSEMBLY INSTALLED ABOVE GROUND WITHIN INSULATED ENCLOSURE PER CCU REQUIREMENTS. ENCLOSURE TO INCLUDE 3" X 6 1/2" DRAIN PORTS/WEEPOLES FOR DISCHARGE WATER ON ONE SIDE OF ENCLOSURE PER CCU REQUIREMENTS.

J. EACH BPA IS REQUIRED TO BE TESTED BY A CCU APPROVED CERTIFIED TESTER PRIOR TO PLACING THE WATER SYSTEM IN SERVICE.

K. SEWER GROUND CLEAN-OUTS SHALL BE PROTECTED FROM BREAKAGE BY A CONCRETE COLLAR OR RECESSED IN A BOX BELOW EXISTING GRADE.

## GENERAL NOTES:

REDUCED PRESSURE PRINCIPLE ASSEMBLIES (RP) MUST CONFORM TO CITY OF CHARLOTTE, MECKLENBURG CO, UTILITY (CMUD) SPECIFICATIONS.

CMUD APPROVED RP INCLUDES SHUT-OFF VALVES #1 AND #2 AS PART OF THE ASSEMBLY. NO SUBSTITUTIONS SHALL BE PERMITTED.

TEST COCK #1 SHALL BE UPSTREAM OF SHUT-OFF VALVE #1 AND IS PART OF THE APPROVED ASSEMBLY.

PIPE MATERIAL AND FITTINGS SHALL BE AS SPECIFIED IN CMU STANDARDS & SPECIFICATIONS.

INSULATED ENCLOSURE SHALL BE AS SPECIFIED IN CCU ENCLOSURE INFORMATION.

ALL LOCATIONS FOR BPA'S REQUIRE CCU APPROVAL.

NO TAPS, BRANCHES, FH'S OR OTHER ACCESSORIES ARE PERMITTED ON THE PIPING BETWEEN THE BPA & METER.

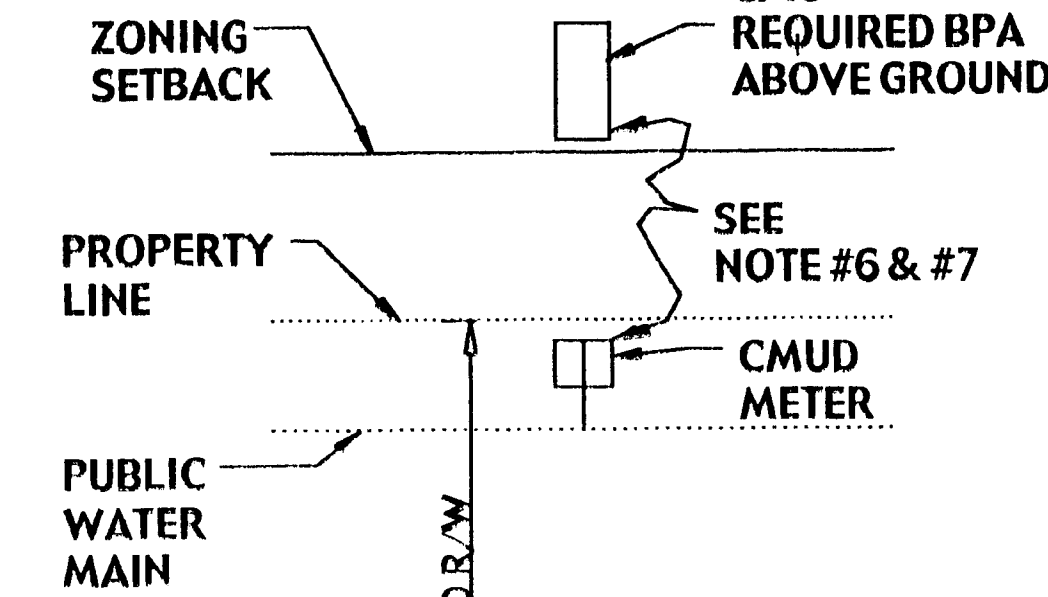

TYPICAL LOCATION REQUIREMENT FOR ABOVE GROUND INSTALLATION  
N.T.S.

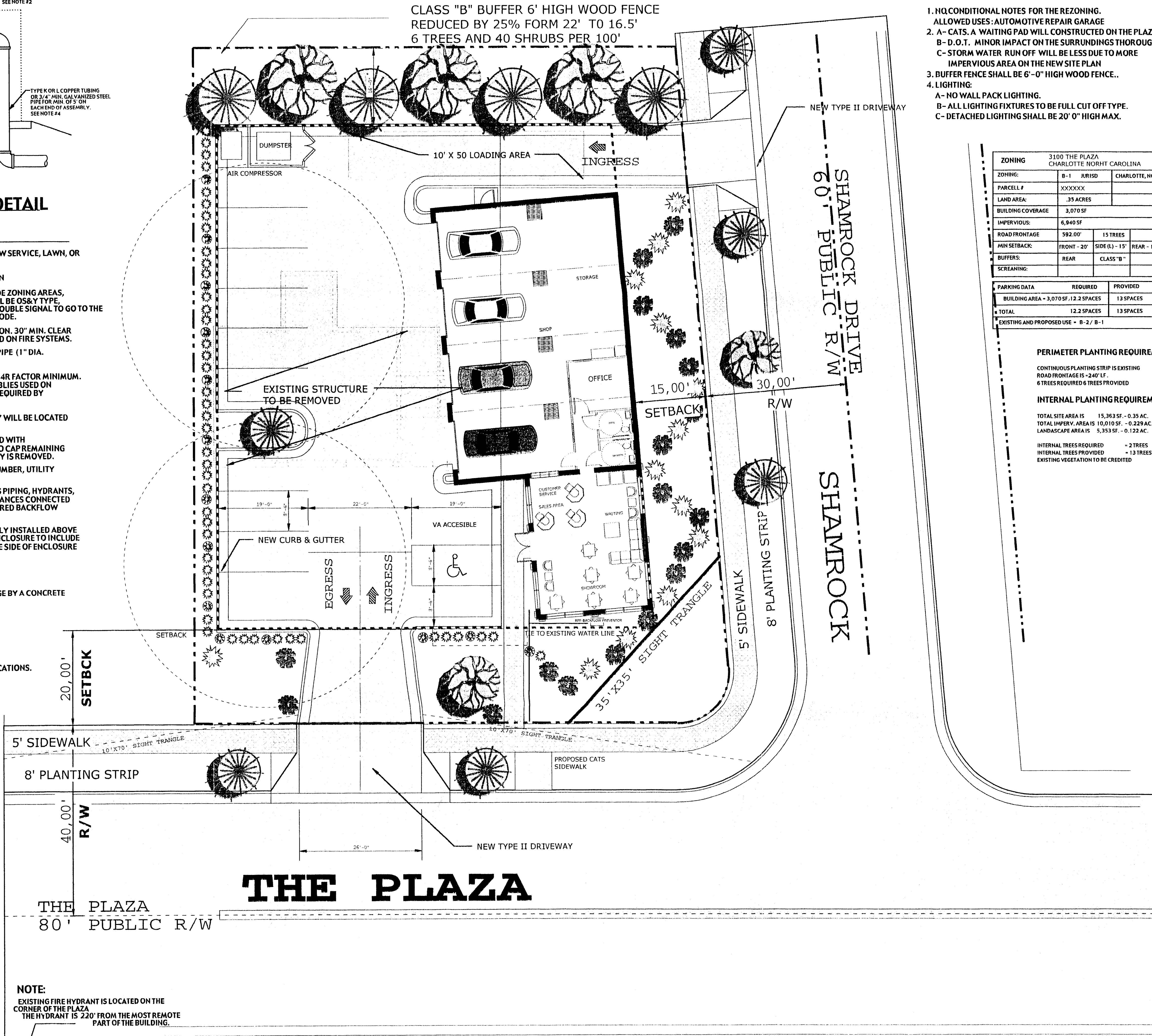

## NOTES:

1. NO CONDITIONAL NOTES FOR THE REZONING.
2. ALLOWED USES: AUTOMOTIVE REPAIR GARAGE
3. A- CATS. A WAITING PAD WILL CONSTRUCTED ON THE PLAZA.
4. B- D.O.T. MINOR IMPACT ON THE SURROUNDINGS THOROUGHFARE.
5. C- STORM WATER RUN OFF WILL BE LESS DUE TO MORE IMPERVIOUS AREA ON THE NEW SITE PLAN
6. 3. BUFFER FENCE SHALL BE 6'-0" HIGH WOOD FENCE..
7. 4. LIGHTING:
8. A- NO WALL PACK LIGHTING.
9. B- ALL LIGHTING FIXTURES TO BE FULL CUT OFF TYPE.
10. C- DETACHED LIGHTING SHALL BE 20' 0" HIGH MAX.

3100 THE PLAZA CHARLOTTE NORTH CAROLINA			
ZONING:	B-1	JURISD	CHARLOTTE, NC
PARCELL #	XXXXXX		
LAND AREA:	.35 ACRES		
BUILDING COVERAGE	3,070 SF		
IMPERVIOUS:	6,940 SF		
ROAD FRONTAGE	592.00'	15 TREES	
MIN SETBACK:	FRONT - 20'	SIDE (L) - 15'	REAR - 10'
BUFFERS:	REAR	CLASS "B"	
SCREENING:			
PARKING DATA	REQUIRED	PROVIDED	
BUILDING AREA = 3,070 SF	12.2 SPACES	13 SPACES	
TOTAL	12.2 SPACES	13 SPACES	
EXISTING AND PROPOSED USE	B-2 / B-1		

### PERIMETER PLANTING REQUIREMENTS

CONTINUOUS PLANTING STRIP IS EXISTING  
ROAD FRONTAGE IS - 240' LF.  
6 TREES REQUIRED 6 TREES PROVIDED

### INTERNAL PLANTING REQUIREMENTS:

TOTAL SITE AREA IS 15,363 SF. - 0.35 AC.  
TOTAL IMPERV. AREA IS 10,010 SF. - 0.229 AC.  
LANDSCAPE AREA IS 5,353 SF. - 0.122 AC.

INTERNAL TREES REQUIRED = 2 TREES  
INTERNAL TREES PROVIDED = 13 TREES  
EXISTING VEGETATION TO BE CREDITED

Design Haus  
1209 MARKET STREET  
SUITE C  
WILMINGTON, N.C. 28401  
Ph.: (910) 471-5640

ARCHITECT SEAL  
ROBERT D. GIBNEY  
4548  
NORTH CAROLINA  
CHARLOTTE, NC

Copyright  
ALL RIGHTS RESERVED  
NO PART OF THIS DOCUMENT MAY BE REPRODUCED OR TRANSMITTED IN ANY FORM OR BY ANY MEANS, ELECTRONIC OR MECHANICAL, WITHOUT PERMISSION IN WRITING FROM THE ARCHITECT.

SPEEDY'S  
TIRE CO.  
3100 THE PLAZA  
CHARLOTTE, NC.

REV DATE DRAWN DESCRIPTION  
APPROVED BY  
CITY COUNCIL  
10/15/2020

sheet title  
SITE PLAN

DRAWN:  
CHECKED:  
APPROVED:  
PROJECT:  
CAD NAME:  
SHEET SIZE:  
PLOT FACTOR:  
DATE:  
SCALE:

DRAWING NUMBER  
C-1