

This document, together with the concepts and designs presented herein, is intended only for the specific purpose and client for which it was prepared. Reuse of and improper reliance on this document without written authorization and adaptation by Kimley-Horn and Associates, Inc. shall be without liability to Kimley-Horn and Associates, Inc.

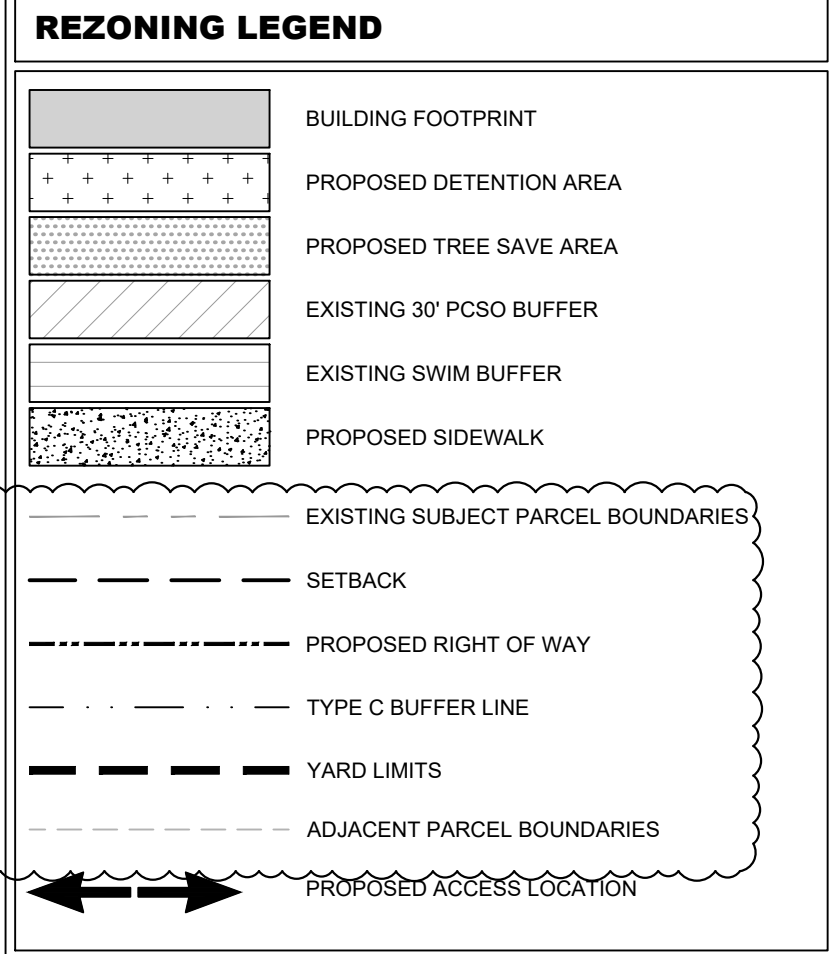

Know what's below.  
Call before you dig.

NOT FOR  
CONSTRUCTION

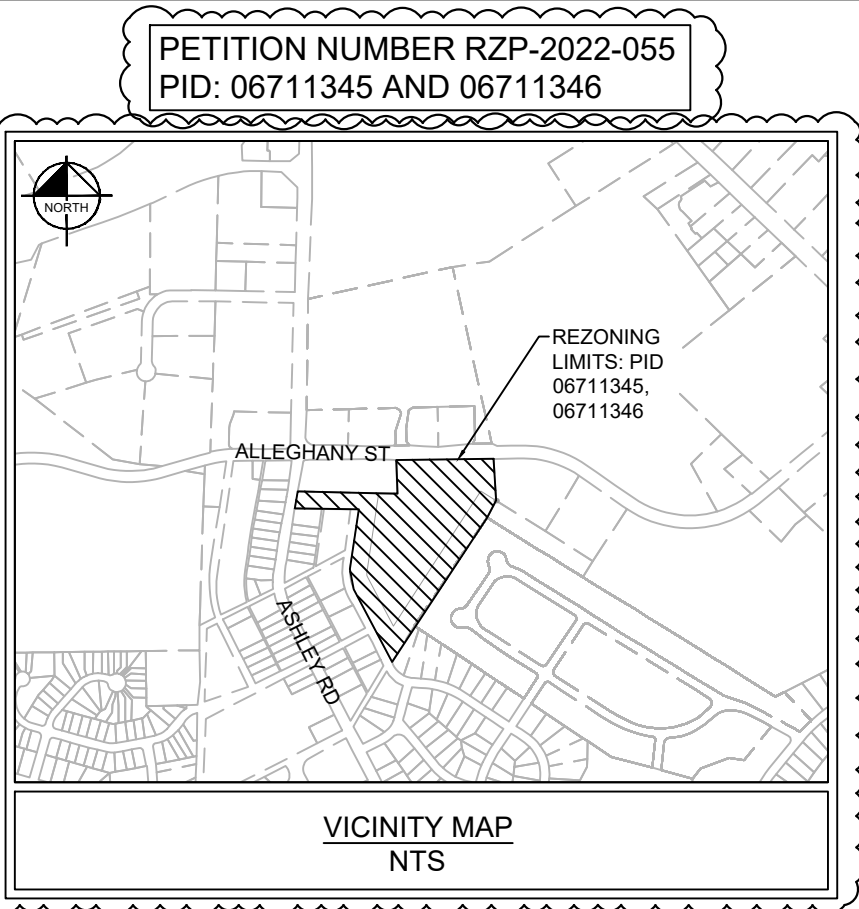
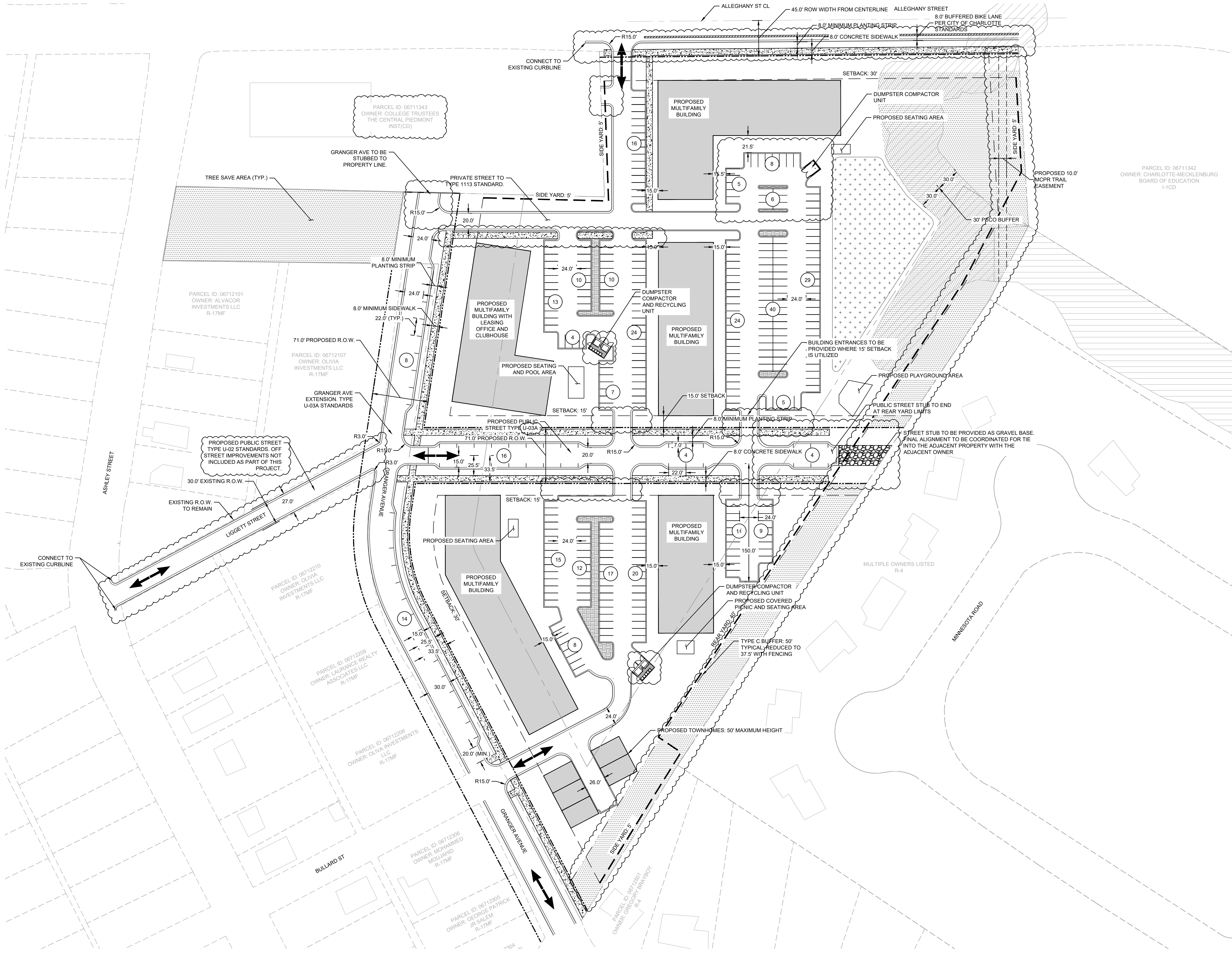

**SITE DATA**

ACREAGE:	12.71 ACRES
TOTAL UNITS:	220 MAX
PARKING PROVIDED:	339 (INCLUDES ON STREET PARKING)
PARKING REQUIRED:	333
TOTAL TREE SAVE AREA	2.54 ACRES = 20% OF TOTAL SITE
REQUIRED RECYCLING AREA:	2 X 144 SF = 432 TOTAL (2 AREAS)
PROVIDED RECYCLING AREA:	2 X 144 SF = 432 TOTAL (2 AREAS)
REQUIRED COMPACTOR UNITS:	1 PER 90 UNITS (220 UNITS) = 3
PROVIDED COMPACTOR UNITS:	3

**NOTE**

FENCING WILL BE PROVIDED WHERE NECESSARY TO DECREASE BUFFER BY 25%.

DEVELOPMENT WITHIN ANY SWIM/PCSO BUFFER SHALL BE COORDINATE WITH AND SUBJECT TO APPROVAL BY CHARLOTTE-MECKLENBURG STORM WATER SERVICES AND MITIGATED IF REQUIRED BY CITY ORDINANCE

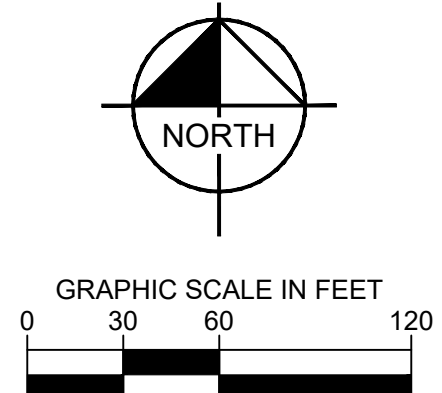

REVISIONS	DATE	BY
No.		
1.	09/12/2022	KH

**Kimley»Horn**

© 2022 KIMLEY-HORN AND ASSOCIATES, INC.  
6750 POPLAR AVENUE, SUITE 600, MEMPHIS TN 38138  
PHONE: 901-374-9109  
WWW.KIMLEY-HORN.COM

**NOT FOR CONSTRUCTION**

KHA PROJECT	DATE	SCALE	DESIGNED BY	DRAWN BY	CHECKED BY
118129091	09/12/2022	AS SHOWN	LNH	DRW	LNH

TECHNICAL DATA  
SHEET  
REZONING PETITION NO.



