

A Resolution to Call for a Public Hearing to Consider Designating the Savona Mill (528 South Turner Avenue) as Local Historic Landmark

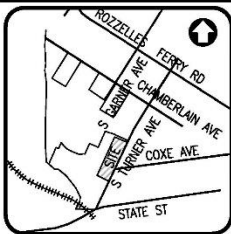

The Savona Mill shows the evolution of industrial architecture with three distinct periods of 20th century industrial construction techniques and materials: the Weave Mill (c. 1916), a 1-story brick building of traditional timber mill construction with exposed beam ends and a wood clerestory roof; the Spinning Mill (c. 1921), a 3-story adjoining brick building of iron/timber fireproof construction with poured concrete foundation, timber beams and floors, and metal columns; and the Paper Warehouse (c. 1951), a 3-story adjoining brick building of reinforced concrete framed construction with concrete mushroom columns and brick infill walls. Originally constructed for the Savona Manufacturing Company, the building was leased in 1931 to Alfred Cotton Mills and sold in 1934 to Old Dominion Box Company. The building was actively used for manufacturing until the 1990s when Old Dominion ceased production at the property. The red shaded area below indicates the general location of the approximately 3.168-acre portion of tax parcel ID no. 07111417 recommended for designation. A more detailed plat of the parcel (identifying the portion recommended for designation as “Area 138,003 Sq. Ft 3.168 Acres”) is also included below.





VICINITY MAP
(NOT TO SCALE)

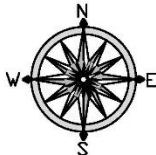

REF: NC GRID (NAD 83) 2011

GENERAL NOTES

1. ALL DISTANCES SHOWN ARE HORIZONTAL GROUND DISTANCES.
2. THE PURPOSE OF THIS MAP IS FOR EXHIBIT ONLY TO AID IN RECORDING OF DEED. NO BOUNDARY SURVEY WAS PERFORMED IN PREPARATION OF THIS MAP AND IS NOT TO BE USED FOR CONVEYANCES OR SALES.
3. THIS MAP IS NOT A CERTIFIED SURVEY AND HAS NOT BEEN REVIEWED BY A LOCAL GOVERNMENT AGENCY FOR COMPLIANCE WITH ANY APPLICABLE LAND DEVELOPMENT REGULATIONS.

LINE TABLE		
LINE	BEARING	DISTANCE
L1	S64°58'02"E	20.00
L2	S25°11'08"W	88.15
L3	N64°35'26"W	143.85
L4	S25°11'08"W	28.31 TIE

CURVE TABLE				
CURVE	RADIUS	ARC LENGTH	CHORD BEARING	CHORD LENGTH
C1	500.00	39.30	N66°50'32"W	39.29

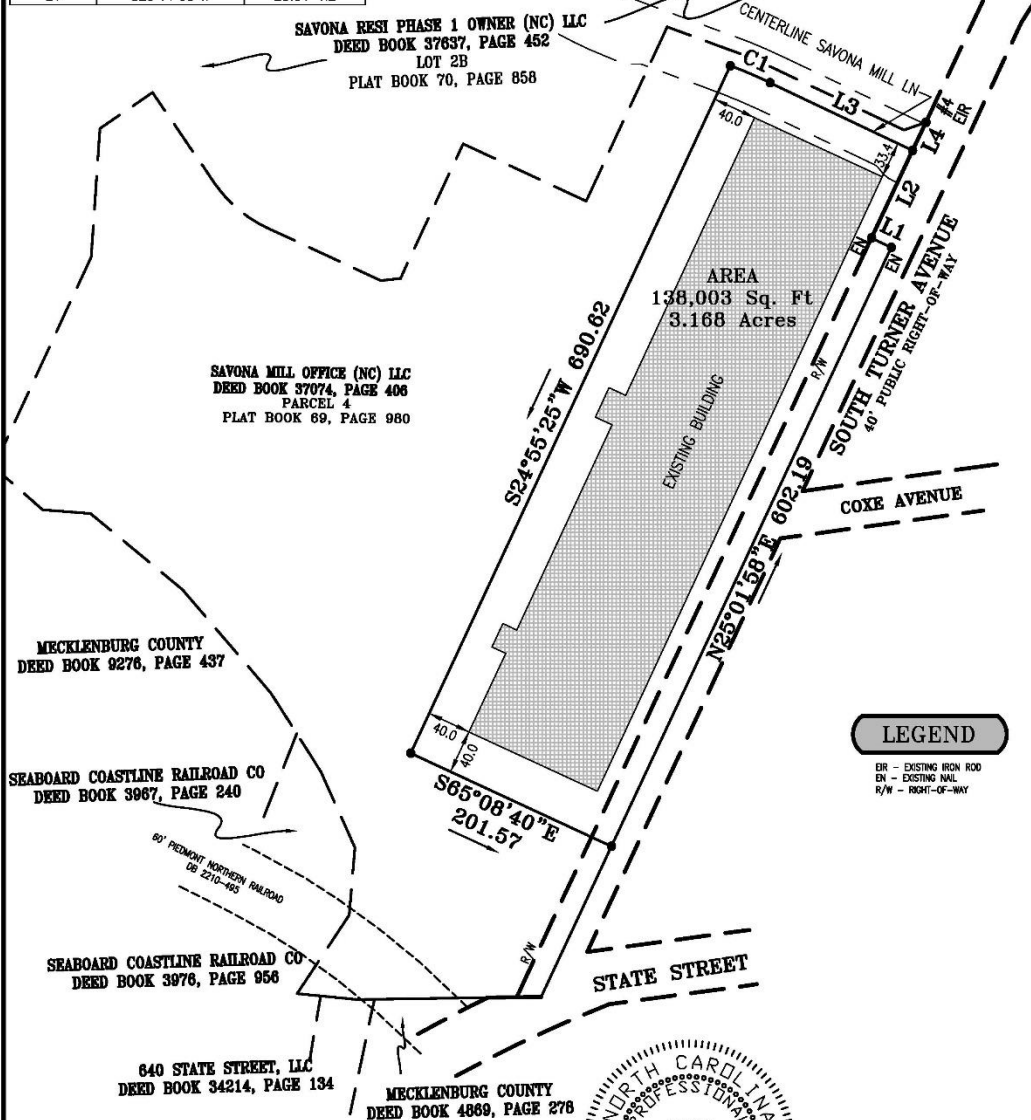

LEGEND

BR - EXISTING IRON ROD
DR - EXISTING WALL
R/W - RIGHT-OF-WAY

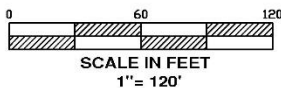

I, JAMES H. MAUNEY, JR., CERTIFY THAT THIS PLAT WAS PREPARED FOR EXHIBIT ONLY AND IS NOT INTENDED TO BE A BOUNDARY SURVEY OF PROPERTY SHOWN

James H. Mauney, Jr.
JAMES H. MAUNEY, JR., PLS
08/22/2023
DATE



PAGE 1 OF 1

SAVONA MILL OFFICE (NC) LLC
528 S TURNER AVE
TAX ID#: 07111417
Deed Book: 37074, Page 406

JM DRAWN	1"=120' SCALE
NA CREW	08/22/2023 DATE

JAMES MAUNEY & ASSOCIATES, P.A.
PROFESSIONAL LAND SURVEYORS
423 BEATTY DRIVE, SUITE E
BELMONT, NC 28012
LICENSE NO. C-2373
TEL: 704-828-9623
WWW.JAMESMAUNEY.COM
JOB NO. 8555