

LEGEND	
	FOCAL POINT ON KEY CORNER
	REQUIRED INTERNAL PRIVATE STREET DESIGNED TO PUBLIC STANDARDS
	PRIVATE ACCESS DRIVE
	BUILDING FRONTAGE AREA
	RETAIL BUILDING CORNER
	PERMISSIBLE PARKING AREA
	SETBACK/BUFFER LINE
	EXISTING RIGHT-OF-WAY
	FUTURE RIGHT-OF-WAY
	FULL MOVEMENT ACCESS POINTS
	POTENTIAL FULL MOVEMENT SITE/BUILDING ACCESS POINTS INTO DEVELOPMENT
	OPTIONAL RIGHT IN/RIGHT OUT MOVEMENT ACCESS POINTS
	AMENITIZED PUBLICLY ACCESSIBLE OPEN SPACE
	EXISTING BUILDING (MAY REMAIN)

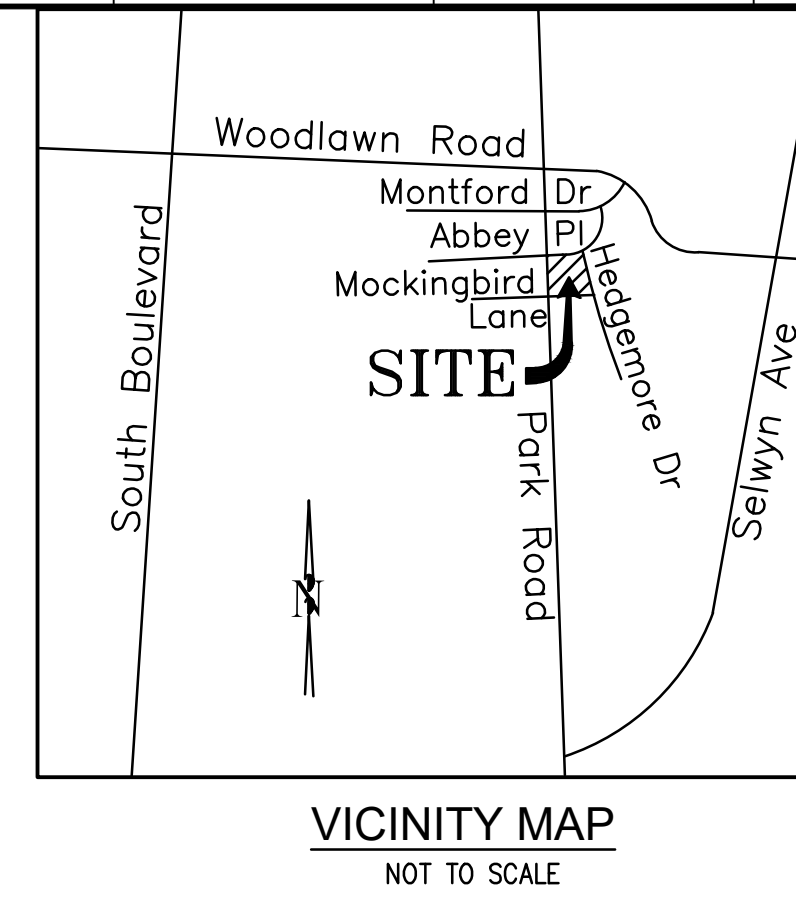

ZONING CODE SUMMARY
 PROJECT NAME: PARK ROAD REDEVELOPMENT
 OWNER: PARK CHARLOTTE, LLC
 CLIENT NAME: GRUBB PROPERTIES, PHONE# (704) 372-5616
 PLANS PREPARED BY: KIMLEY-HORN AND ASSOCIATES PHONE# (704)333-5131
 TAX PARCEL ID: 17514405
 STREET ADDRESS: PARK ROAD AT ABBEY PLACE
 EXISTING ZONING: MUDD-O
 PROPOSED ZONING: MUDD-O
 PROPOSED USE: MIXED USE - RETAIL/OFFICE/MULTIFAMILY
 PROPOSED BUILDING HEIGHT: AS ALLOWED BY THE APPLICABLE ZONING DISTRICT. SEE TECHNICAL DEVELOPMENT STANDARDS (RZ-2) FOR MORE INFORMATION.
 EXISTING LOT SIZE: ±10.66 ACRES
 JURISDICTION: CITY OF CHARLOTTE

DATE: _____ BY: _____

REVISIONS: _____

ISSUED FOR PERMIT: _____

UPDATES PER CITY COMMENTS: _____

UPDATES PER CITY COMMENTS: _____

12/20/2023: _____

8/14/2023: _____

Kimley-Horn

© 2023 KIMLEY-HORN AND ASSOCIATES, INC.
 200 SOUTH TRYON ST., SUITE 200, CHARLOTTE, NC 28202
 WWW.KIMLEY-HORN.COM
 NC LICENSE # F-0102

NOT FOR CONSTRUCTION

KH PROJECT	018740008	DATE	01/31/2023	SCALE	AS SHOWN
DESIGNED BY	LIKH	DRAWN BY	LIKH	CHECKED BY	RTL

TECHNICAL DATA SHEET

PARK ROAD REDEVELOPMENT

PARK RD AT ABBEY PLACE

CHARLOTTE, NC

SHEET NUMBER: RZ-1

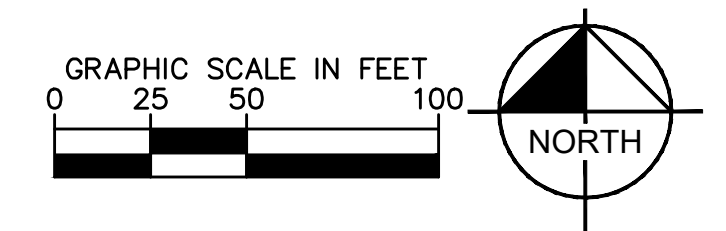

This document, together with the concepts and designs presented herein, as an instrument of service, is intended only for the specific purpose and client for which it was prepared. Reuse of and improper reliance on this document without written authorization and adaptation by Kimley-Horn and Associates, Inc. shall be without liability to Kimley-Horn and Associates, Inc.

