

SITE DATA

TAX MAP NO: 02931108A, 02930127, 02930133, 02930132 02930198, 02930349
SITE AREA: ±41.91 ACRES

EXISTING ZONING: R-3
PROPOSED ZONING: UR-3(CD)

EXISTING USES: SINGLE FAMILY/VACANT/TREE FARM
PROPOSED USES: MULTIFAMILY APARTMENTS FOR RENT, TOWNHOME APARTMENTS FOR RENT, SENIOR RENTAL HOUSING, AND/OR CHILDCARE CENTER

PROPOSED UNITS: 440 UNITS TOTAL (MINIMUM 120 SENIOR HOUSING UNITS)
PROPOSED DENSITY: ±10.50 UNITS PER ACRE

PARKING PROVIDED: SHALL MEET ORDINANCE REQUIREMENTS

OPEN SPACE PROVIDED: SHALL MEET ORDINANCE REQUIREMENTS

WATERSHED: MALLARD WATERSHED

BUILDING HEIGHT: PER ORDINANCE

POTENTIAL TREE SAVE AREAS (TYP.)
15% MIN (±5.96 ACRES) OF 39.75 ACRE SITE TO BE PRESERVED.
FINAL LIMITS OF 15% MAY VARY FROM WHAT IS DEPICTED ON REZONING PLAN.
FINAL LIMITS WILL BE ESTABLISHED DURING PERMITTING.

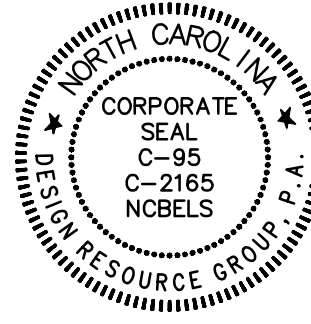
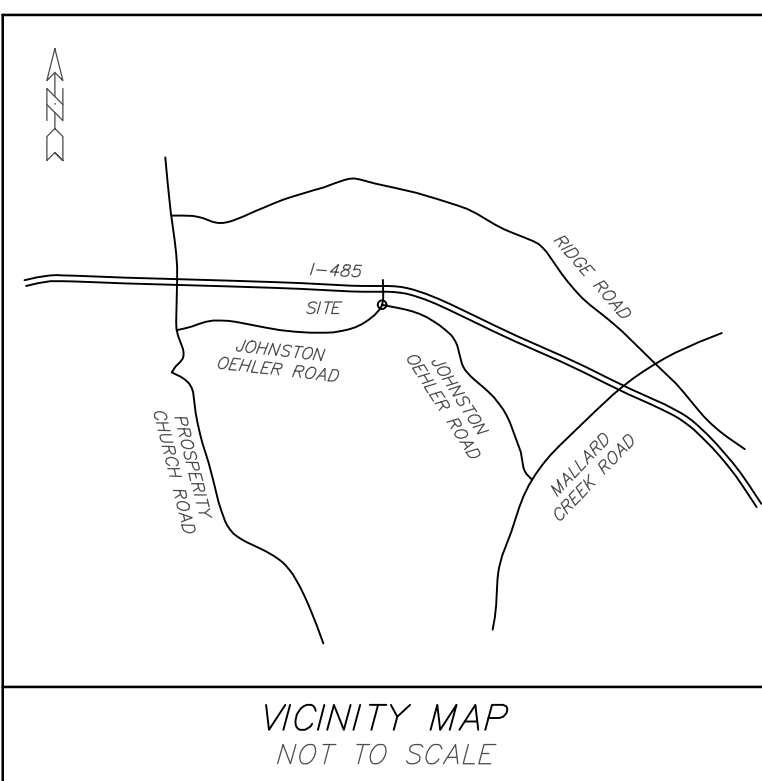

REZONING PETITION
FOR PUBLIC HEARING
2019-078

REZONING PETITION

JOHNSTON OEHLER SITE
CHARLOTTE, NORTH CAROLINA
CHARTER PROPERTIES, INC.
1520 SOUTH BOULEVARD, SUITE 215
CHARLOTTE, NC 28203
704.377.4172

SCHEMATIC
SITE PLAN

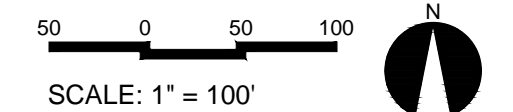

PROJECT #: 278-033
DRAWN BY: JO
CHECKED BY: NB

MAY 3, 2019

REVISIONS:
1. 08.12.19 PER REVIEW COMMENTS
2. 08.12.19 PER SITE UPDATES
3. 10.25.19 PER SITE UPDATES

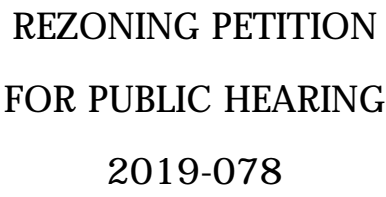

JOHNSTON OEHLER SITE

CHARLOTTE, NORTH CAROLINA

CHARTER PROPERTIES, INC.

1520 SOUTH BOULEVARD, SUITE 215
CHARLOTTE, NC 28203

704.377.4172

PROJECT #: 278-033
DRAWN BY: JO
CHECKED BY: NB

MAY 3, 2019

REVISIONS:

1. 08.12.19 PER REVIEW COMMENTS
2. 09.12.19 PER SITE UPDATES
3. 10.25.19 PER SITE UPDATES