

Plotted By: Shirley, Sara - Sheet Set: CLT-ID_SSM_TEMPLATE - Layout: RZ-01 - April 10, 2023 - 02:16:49pm - \\kimley-horn.com\d..._CHL_PJA14364 - BrownGroup_0000 - Charlotte - LeGranger - 2023.04.10.dwg

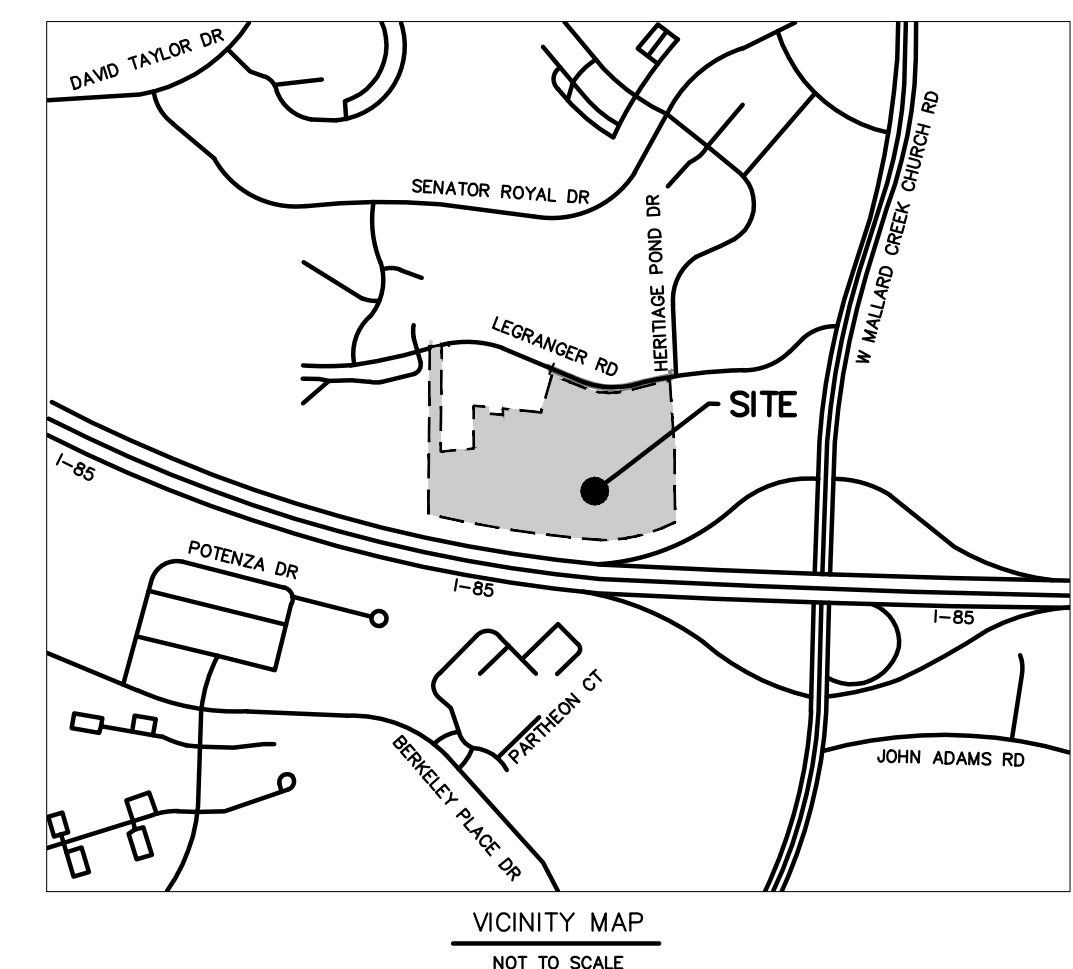
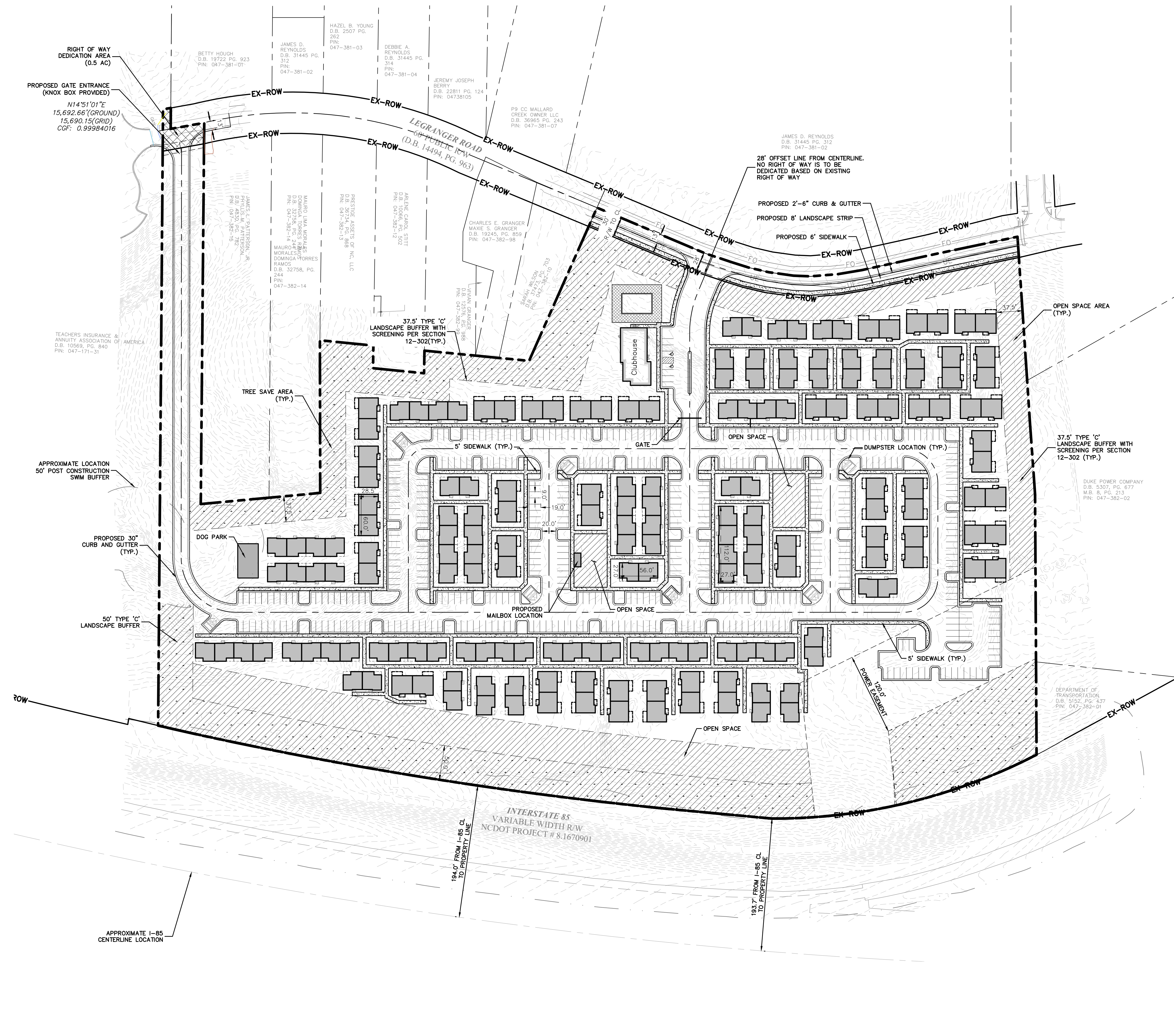

SITE DATA TABLE	
DEVELOPMENT DATA:	
TAX PARCEL ID:	04717118, 04738205, 04738206, 04738207, 04738208 & 04738209
LAND USE:	RESIDENTIAL AND VACANT
TOTAL SITE AREA:	±19.79 ACRES
TOTAL R.O.W. AREA:	± 0 ACRES
TOTAL DISTURBED AREA:	±16.41 ACRES
TOTAL NUMBER OF UNITS:	184
ZONING DATA:	
FEMA FLOOD PANEL:	3710457700K
WATERSHED:	MALLARD
PC DISTRICT:	YADKIN - SOUTHEAST CATAWBA
ZONING DISTRICT:	CURRENT: RE-1 PROPOSED: RE-3
ZONING STANDARDS	
MIN. BLDG SEPARATION:	10 FT
MAX. BUILDING HEIGHT PER ORDINANCE:	
PROPOSED DENSITY:	9.30 DU/A
SETBACK:	30'
SIDE YARD:	MIN. 35'
REAR YARD:	MIN. 35'
OPEN SPACE:	
REQUIRED:	1.98 AC (10%)
IMPERVIOUS AREA:	
PROPOSED:	±9.15 AC
EXISTING:	0.04 AC
TREE SAVE:	
REQUIRED:	2.97 AC (15.0%)

TREE SAVE CALCULATIONS (PER SECTION 21-94 & 21-95)	
TOTAL BOUNDARY ACREAGE:	±19.79 AC
TREE SAVE CALCULATIONS:	15% TOTAL SITE
TOTAL TREE SAVE REQUIRED (15%):	2.97 AC
TOTAL TREE SAVE PROVIDED:	PER ORDINANCE

- EX-ROW
- R/W LINE
- PROPERTY LINE/REZONING BOUNDARY
- COMMON OPEN SPACE
- COMMON OPEN SPACE & TREE SAVE
- PROPOSED DWELLING UNIT
- PROPOSED SIDEWALK
- PROPOSED RIGHT OF WAY DEDICATION

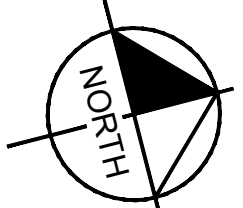
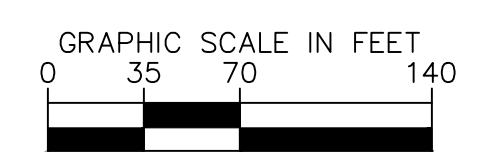

NO.	REVISIONS	DATE	BY

Kimley-Horn
 © 2022 KIMLEY-HORN AND ASSOCIATES, INC.
 200 SOUTH IRYON ST., SUITE 200, CHARLOTTE, NC 28202
 WWW.KIMLEY-HORN.COM
 NC LICENSE # F-0102

NOT FOR CONSTRUCTION

KH PROJECT	014364000
DATE	09/01/2022
SCALE	AS SHOWN
DESIGNED BY	JJS
DRAWN BY	JJS
CHECKED BY	JEH

REZONING PLAN

LEGRANGER
 PREPARED FOR
BROWN GROUP, INC
 NORTH CAROLINA

SHEET NUMBER
RZ-01

THIS PLAN IS CONCEPTUAL IN NATURE AND IS SUBJECT TO CHANGE BASED ON FINAL DESIGN AND APPROVALS
 This document, together with the concepts and designs presented herein, as an instrument of service, is intended only for the specific purpose and client for which it was prepared. Reuse of and improper reliance on this document without written authorization and adaptation by Kimley-Horn and Associates, Inc. shall be without liability to Kimley-Horn and Associates, Inc.

