

VICINITY MAP

South Central Oil Co., Inc.
D.B. 26948 Pg. 643,
D.B. 6545 Pg. 499

4-story concrete building
No. 1300 Baxter Street
(16,020 S.F., exterior
footprint at ground level)

Midtown Area
Partners, LLC
PID 125-214-13
D.B. 28034 Pg. 652

Midtown Centre
Parking Deck
(LDU PED 3013-00015)

BAXTER STREET
52' PUBLIC R/W
(D.B. 28057 PG. 225)

CECIL STREET
40' PUBLIC R/W

SOUTH KINGS DRIVE
(MAJOR THOROUGHFARE)
VARIABLE (PER GIS)

BEFORE YOU DIG
CALL 1-800-632-4949
N.C. ONE-CALL CENTER
IT'S THE LAW

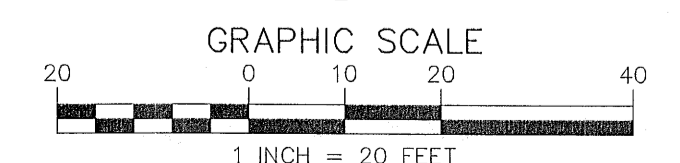

DEVELOPMENT SUMMARY:

TAX PARCEL ID #:	125-228-02
TOTAL SITE AREA:	0.292 AC
REZONING AREA:	0.149 AC
ZONING:	
EXISTING:	B-1/UR-C(CD)
PROPOSED:	B-1(CD)
ALLOWED USE:	OFFICE/RETAIL EDEE TYPE 1
SETBACKS: (PER PED REQUIREMENTS)	
FRONT:	18'
SIDE:	0'
REAR:	5'
BUILDING AREA:	5,800 SF
PARKING:	1 SP PER 600 SF (PER PED OVERLAY REQUIREMENTS)
NOTE:	SIGNAGE WILL COMPLY WITH REQUIREMENTS OF THE SIGN ORDINANCE.

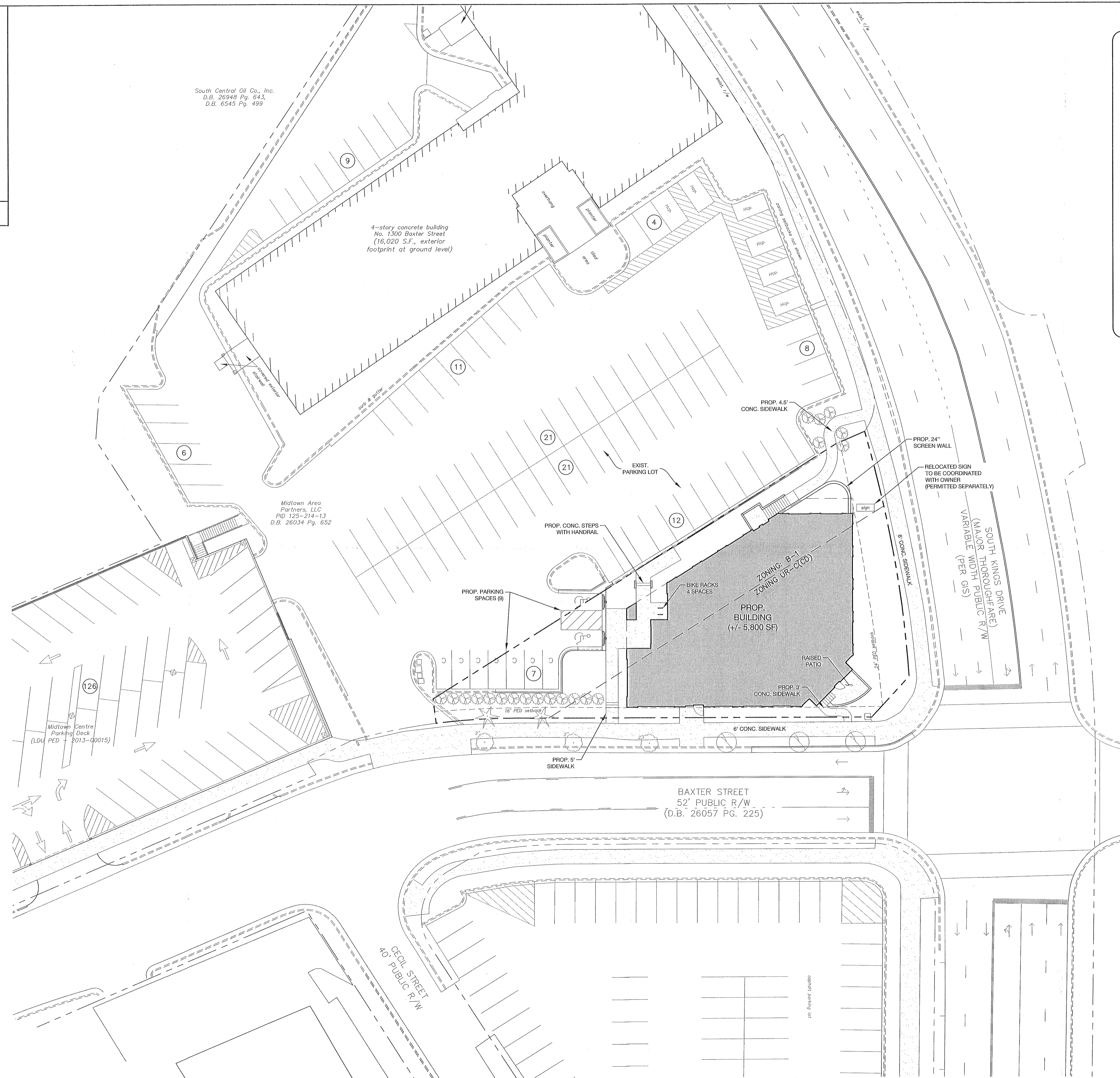

Goode Development

Mr. Roy Goode
1300 Baxter Street, Suite 270
Charlotte, NC 28204

**Midtown Centre
Building Two - Novant Office**

Rezoning Site Plan
445 Kings Drive Charlotte, NC

NO. DATE BY: REVISIONS:

Project No: 15-073
Date: 08/20/15
Designed by: udp
Drawn By: udp
Scale: 1"=20'
Sheet No:

RZ-1.0