

LEGEND	
	FOCAL POINT ON KEY CORNER
	REQUIRED INTERNAL PRIVATE STREET DESIGNED TO PUBLIC STANDARDS
	PRIVATE ACCESS DRIVE
	BUILDING FRONTAGE AREA
	RETAIL BUILDING CORNER
	PERMISSIBLE PARKING AREA
	SETBACK/BUFFER LINE
	EXISTING RIGHT-OF-WAY
	FUTURE RIGHT-OF-WAY
	FULL MOVEMENT ACCESS POINTS
	POTENTIAL FULL MOVEMENT SITE/BUILDING ACCESS POINTS INTO DEVELOPMENT
	OPTIONAL RIGHT IN/RIGHT OUT MOVEMENT ACCESS POINTS
	AMENITIZED PUBLICLY ACCESSIBLE OPEN SPACE
	EXISTING BUILDING (MAY REMAIN)

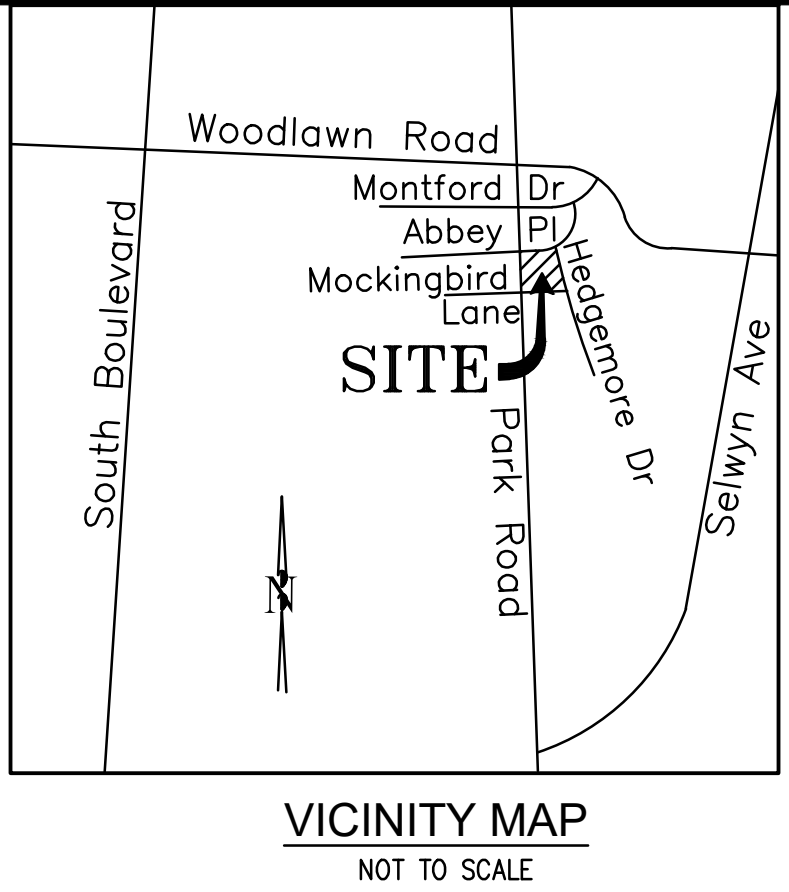

**ZONING CODE SUMMARY**  
 PROJECT NAME: PARK ROAD REDEVELOPMENT  
 OWNER: PARK CHARLOTTE, LLC  
 CLIENT NAME: GRUBB PROPERTIES, PHONE# (704) 372-5616  
 PLANS PREPARED BY: KIMLEY-HORN AND ASSOCIATES PHONE# (704)333-5131  
 TAX PARCEL ID: 17514405  
 STREET ADDRESS: PARK ROAD AT ABBEY PLACE  
 EXISTING ZONING: MUDD-O  
 PROPOSED ZONING: MUDD-O  
 PROPOSED USE: MIXED USE - RETAIL/OFFICE/MULTIFAMILY  
 PROPOSED BUILDING HEIGHT: AS ALLOWED BY THE APPLICABLE ZONING DISTRICT. SEE TECHNICAL DEVELOPMENT STANDARDS (RZ-2) FOR MORE INFORMATION.  
 EXISTING LOT SIZE: ±10.66 ACRES  
 JURISDICTION: CITY OF CHARLOTTE

**Kimley-Horn**  
 © 2023 KIMLEY-HORN AND ASSOCIATES, INC.  
 200 SOUTH TRYON ST., SUITE 200, CHARLOTTE, NC 28202  
 WWW.KIMLEY-HORN.COM  
 NC LICENSE # F-0102

**NOT FOR CONSTRUCTION**

KH PROJECT	018740008
DATE	01/31/2023
SCALE	AS SHOWN
DESIGNED BY	LKH
DRAWN BY	LKH
CHECKED BY	RTL

**TECHNICAL DATA SHEET**

**PARK ROAD REDEVELOPMENT**  
 PARK RD AT ABBEY PLACE

SHEET NUMBER  
**RZ-1**

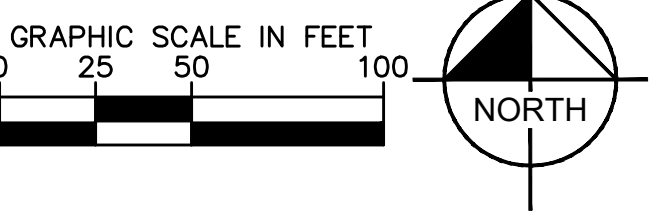

This document, together with the concepts and designs presented herein, is intended only for the specific purpose and client for which it was prepared. Reuse of and improper reliance on this document without written authorization and adaptation by Kimley-Horn and Associates, Inc. shall be without liability to Kimley-Horn and Associates, Inc.

